

REVISIONS		DATE	APPROVED
CHANGE ORDER	LTR	DESCRIPTION	
009035	1	ADDED TOLERANCES & PART NDS	09/25/09

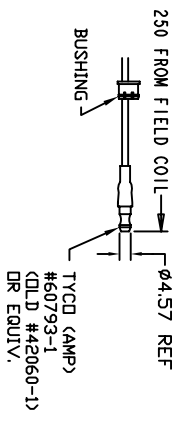

TERMINAL LEAD DETAIL

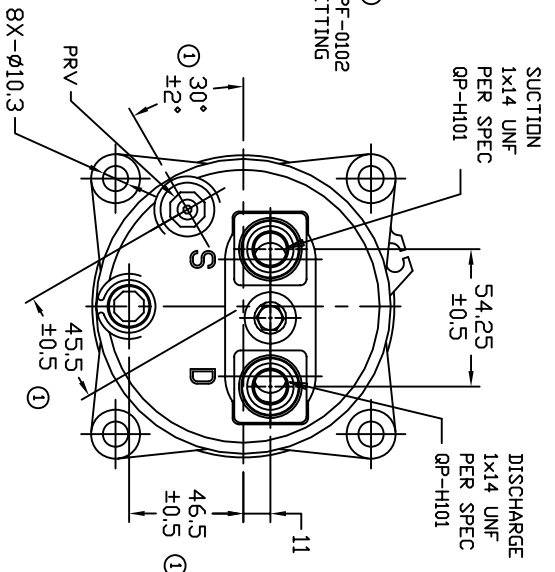
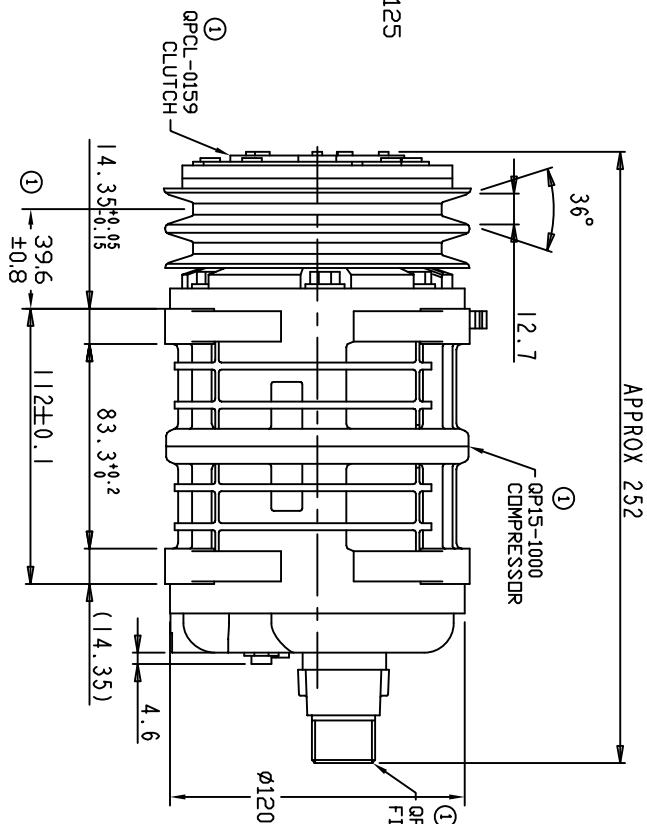
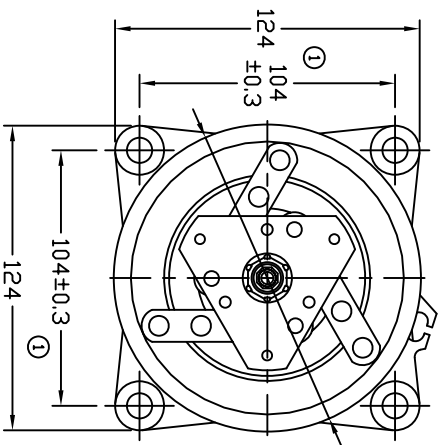

**CLUTCH SPECIFICATIONS:**

- VOLTAGE..... 12 VDC
- BELT..... A2
- STATIC TORQUE  
INITIAL..... 35 Nm (3.5 Kgfm)  
AFTER BURNISHING..... 49 Nm (5 Kgfm)
- MAX POWER CONSUMPTION..... 45W @ 25°C
- ROTATION DIRECTION..... CW OR CCW
- WEIGHT..... 2.30 Kg

**COMPRESSOR SPECIFICATIONS:**

- MODEL..... QP15HD
- NUMBER OF CYLINDERS..... 6
- BORE X STROKE..... 36 X 24.0 mm
- DISPLACEMENT..... 146.7 cm<sup>3</sup>/REV
- SPEED RANGE..... 700 - 6000 RPM
- ROTATION DIRECTION..... CW OR CCW
- REFRIGERANT..... R-134a
- LUBRICANT..... PAG 46 150+20cm<sup>3</sup>
- WEIGHT..... 4.4 Kg

UNLESS OTHERWISE SPECIFIED  
 DIMENSIONS ARE IN MM. PER  
 INTERPRET DIM AND TOL. PER  
 ASME Y14.5M - 1994

THIRD ANGLE PROJECTION

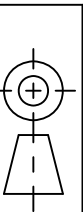

**DAVE PRODUCTS, LLC**

TITLE  
 COMPRESSOR ASSEMBLY  
 QP15HD H-1 X 14

A2 125MM 12V LEAF SPRING  
 QP15-1168

SCALE NONE SHEET 1 OF 1